

TM500A75 SERIES

(20.0" diameter)

DIMENSIONS (in inches)

TM500A75 Drum Motor (matching Idler KT500A75**)

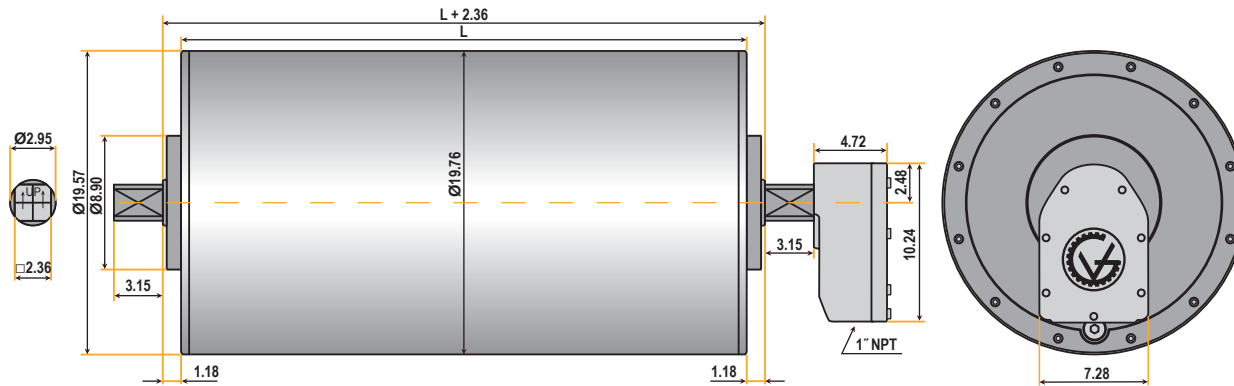

Standard face widths* (L) in inches:

33.46	35.43	37.40	39.38	41.34	43.31	45.28	47.24	49.21
51.18	53.15	55.12	57.09	59.06	61.02	62.99	64.96	66.93
68.90	70.87							

Bracket AB 75

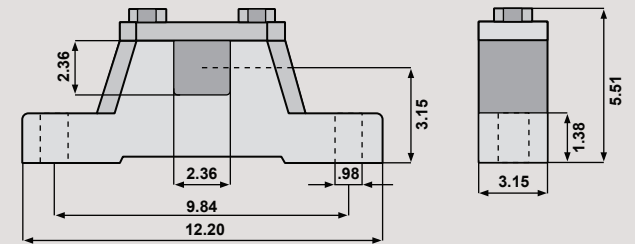

Optional Cable Type

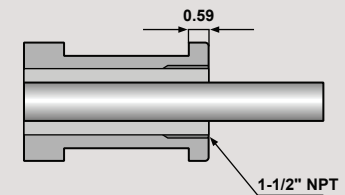

Note: When Optional Cable Type is selected, the minimum face width (L) increases by 5.91 inches.

*Some face widths are not available in all horsepower. For minimum available face widths refer to TM500 Specifications.

**Idler dimensions are identical to the drum motor with no junction box.



TM500A75 SERIES**(20.0" diameter)****SPECIFICATIONS**

TM500A75 - 450 (50.0 HP 1740 RPM)				Minimum Face Width (L): DESIGN A = 37.40" WEIGHT = 1100.0 LBS. @ L=33.46"	
V (ft/min)	750	590	468	368	
NLV (ft/min)	771	607	481	379	
BP (lbs)	2199	2795	3524	4481	
T' lbs.	1793	2279	2873	3654	
WITH 0.25" LAGGING					
V (ft/min)	769	605	480	377	
NLV (ft/min)	791	622	493	388	
BP (lbs)	2144	2725	3436	4370	
T' lbs.	1793	2279	2873	3654	
TM500A75 - 440 (40.0 HP 1740 RPM)				Minimum Face Width (L): DESIGN A = 37.40" WEIGHT = 1100.0 LBS. @ L=33.46"	
V (ft/min)	750	590	468	368	
NLV (ft/min)	771	607	481	379	
BP (lbs)	1763	2241	2825	3592	
T' lbs.	1450	1843	2324	2954	
WITH 0.25" LAGGING					
V (ft/min)	769	605	480	377	
NLV (ft/min)	791	622	493	388	
BP (lbs)	1719	2185	2756	3503	
T' lbs.	1450	1843	2324	2954	
TM500A75 - 430 (30.0 HP 1740 RPM)				Minimum Face Width (L): DESIGN A = 33.46" WEIGHT = 1100.0 LBS. @ L=33.46"	
V (ft/min)	750	590	468	368	
NLV (ft/min)	771	607	481	379	
BP (lbs)	1322	1680	2119	2694	
T' lbs.	1087	1382	1743	2216	
WITH 0.25" LAGGING					
V (ft/min)	769	605	480	377	
NLV (ft/min)	791	622	493	388	
BP (lbs)	1289	1639	2067	2627	
T' lbs.	1087	1382	1743	2216	
TM500A75 - 425 (25.0 HP 1740 RPM)				Minimum Face Width (L): DESIGN A = 33.46" WEIGHT = 1078.0 LBS. @ L=33.46"	
V (ft/min)	750	590	468	368	
NLV (ft/min)	771	607	481	379	
BP (lbs)	1102	1400	1766	2245	
T' lbs.	906	1152	1452	1846	

V = Velocity **NLV** = No Load Velocity **BP** = Belt Pull **T** = Torque **RPM** = Internal Electric Motor RPM

NOTE: Total weight of the unit increases by 14.39 lbs. per inch above 33.46 inches.

All drum motors are available in all standard voltages and are electrically reversible. Other belt speeds and face widths are available. Please consult **Van der Graaf: +1 905 793-8100**.



TM500A75 SERIES**(20.0" diameter)****SPECIFICATIONS****WITH 0.25" LAGGING**

V (ft/min)	769	605	480	377
NLV (ft/min)	791	622	493	388
BP (lbs)	1074	1366	1722	2189
T ' lbs.	906	1152	1452	1846

TM500A75 - 620 (20.0 HP 1150 RPM) Minimum Face Width (L): DESIGN A = 33.46" WEIGHT = 1100.0 LBS. @ L=33.46"

V (ft/min)	500	393	312	245
NLV (ft/min)	514	405	321	252
BP (lbs)	1322	1680	2119	2694
T ' lbs.	1087	1382	1743	2216

WITH 0.25" LAGGING

V (ft/min)	513	403	320	251
NLV (ft/min)	527	415	329	259
BP (lbs)	1289	1639	2067	2627
T ' lbs.	1087	1382	1743	2216

TM500A75 - 815 (15.0 HP 875 RPM) Minimum Face Width (L): DESIGN A = 33.46" WEIGHT = 1100.0 LBS. @ L=33.46"

V (ft/min)	375	295	234	184
NLV (ft/min)	386	303	240	189
BP (lbs)	1322	1680	2119	2694
T ' lbs.	1087	1382	1743	2216

WITH 0.25" LAGGING

V (ft/min)	384	302	240	189
NLV (ft/min)	395	311	247	194
BP (lbs)	1289	1639	2067	2627
T ' lbs.	1087	1382	1743	2216

V = Velocity **NLV** = No Load Velocity **BP** = Belt Pull **T** = Torque **RPM** = Internal Electric Motor RPM

NOTE: Total weight of the unit increases by **14.39 lbs. per inch above 33.46 inches.**

All drum motors are available in all standard voltages and are electrically reversible. Other belt speeds and face widths are available. *Please consult Van der Graaf: +1 905 793-8100.*



TM500A75 SERIES

(20.0" diameter)

CROSS SECTIONAL & PARTS DESCRIPTION

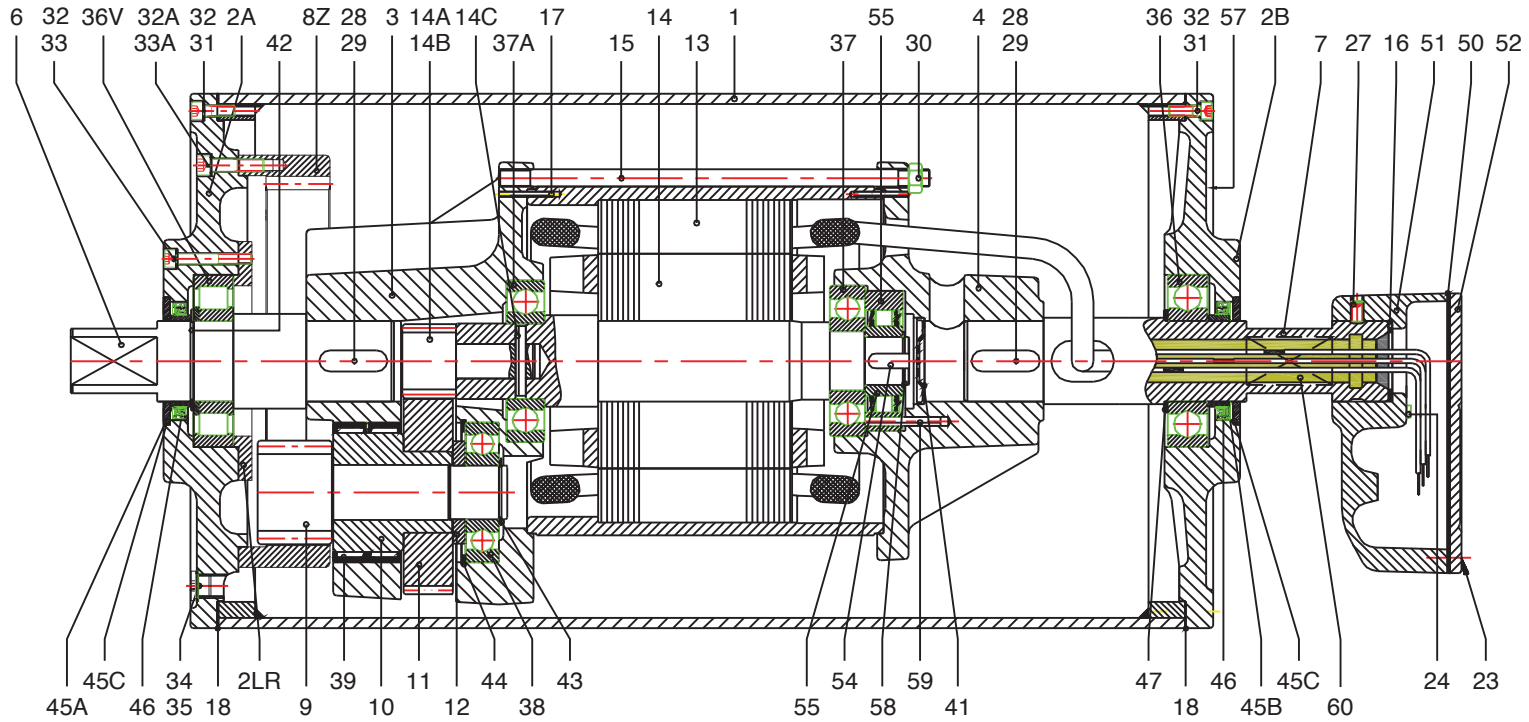

ITEM	PART DESCRIPTION	ITEM	PART DESCRIPTION	ITEM	PART DESCRIPTION	ITEM	PART DESCRIPTION
1	Shell	14 C	Spiral Pin	32 A	Bonded Seal Washer	45 B	Bearing race
2A	End Flange	15	Threaded Rod	33A	Set Screw	45C	End Plate
2B	End Flange	16	Cable Passage	34	Filler Plug	46	Cassette Seal
2LR	Locking Ring	17	Spiral Pin	35	Washer	47	Shim
3	Gear Housing	18	Gasket	36	Ball Bearing	50	Seal
4	Motor Flange	20	Terminal Board	36V	Cylindrical Roller Bearing	51	Junctin Box
6	Shaft End	23	Fillister head Machine Screw	37	Ball Bearing	52	Junction Box Cove
7	Hollow Shaft	24	Fillister head Machine Screw	37 A	Ball Bearing	53	Plug
8 Z	Internal Gear	27	Set Screw	38	Ball Bearing	54	Key - Optional
9/10	Pinion with Bushing	28	Set Screw	39	Needle Bearing	55	Backstop Bearing - Optional
11	Gear	29	Key	41	Disc	57	Data Plate
12	Distance Ring	30	Nut	42	Snap Ring	58	Snap Ring - Optional
13	Stator	31	Socket Head Cap Screw	43	Snap Ring	59	Spiral Pin - Optional
14	Rotor	32	Bonded Seal Washer	44	Snap Ring	60	Epoxy Resin
14 A/B	Insert Pinion	33	Socket Head Cap Screw	45 A	Bearing race		